

Axpert VM III Off-Grid Inverter



LCD Display Panel



Axpert VM III Off-Grid Inverter

• Detachable LCD control module with various communications

This detachable LCD control module can be turned to remote panel. Users can install the LCD panel in accessible area away from inverter up to 20 meters.

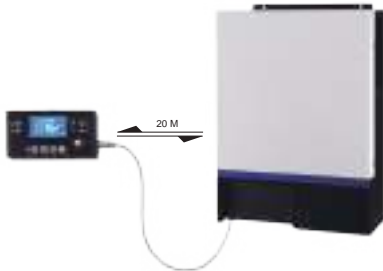

• Reserved communication port (RS-485, CAN-BUS or RS-232) for BMS

This third generation inverter is reserved communication port for BMS. For the detailed information, please contact sales directly.



• Battery equalization extends lifecycle

This inverter charger is built in battery equalization function. This function will help remove sulfation to optimize battery performance and even extend lifecycle.

• Integrated Bluetooth interface with Android App

VM III series is integrated Bluetooth interface ready for mobile monitoring. This technology allows wireless communication up to 6~7m in an open space. Now, WatchPower App is available in google store.



• Battery independency

Inverter can keep supplying power to the loads from PV energy or the grid without battery connected.

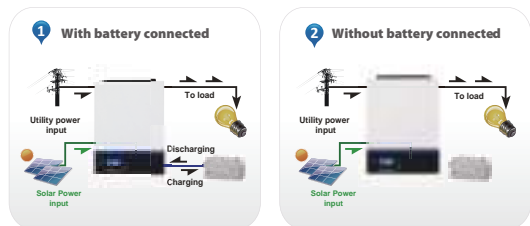

• Supports USB On-the-Go function

VM III series supports USB On-the-Go function to facilitate data upload/download.

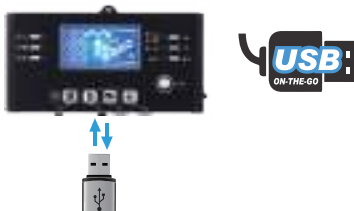

• User-friendly LCD operation

Users can easily set up or change the charging current, output source and charger source prioritization through LCD control panel to optimize inverter performance.



• Replaceable fan design

VM III series is designed with replaceable fan. It will simplify the maintenance and reduce the maintenance cost.



Axpert VM III Off-Grid Inverter Selection Guide

MODEL	Axpert VM III-1500-24	Axpert VM III-3000-24	Axpert VM III 5000-48
Rated Power	1500VA/1500W	3000VA/3000W	5000VA/5000W
INPUT			
Voltage	230 VAC		
Selectable Voltage Range	170-280 VAC (For Personal Computers) 90-280 VAC (For Home Appliances)		
Frequency Range	50 Hz/60 Hz (Auto sensing)		
OUTPUT			
AC Voltage Regulation (Batt. Mode)	230VAC \pm 5%		
Surge Power	3000VA	6000VA	10000VA
Efficiency (Peak)	90% ~ 93%		
Transfer Time	15 ms (For Personal Computers) 20 ms (For Home Appliances)		
Waveform	Pure sine wave		
BATTERY			
Battery Voltage	24 VDC		48 VDC
Floating Charge Voltage	27 VDC		54 VDC
Overcharge Protection	33 VDC		63 VDC
SOLAR CHARGER & AC CHARGER			
Solar Charger type	MPPT		
Maximum PV Array Power	2000W	4000W	5000W
MPP Range @ Operating Voltage	120 ~ 380 VDC	120 ~ 450 VDC	
Maximum PV Array Open Circuit Voltage	400 VDC	500 VDC	
Maximum Solar Charge Current	60A	100A	
Maximum AC Charge Current	40A	100A	
Maximum Charge Current	60A	100A	
PHYSICAL			
Dimension, D x W x H (mm)	100 x 280 x 390	115 x 300 x 400	
Net Weight (kgs)	8.5	9	10
Communication Interface	USB/RS232/RS485/Bluetooth/Dry-contact		
OPERATING ENVIRONMENT			
Humidity	5% to 95% Relative Humidity (Non-condensing)		
Operating Temperature	-10°C to 50°C		
Storage Temperature	-15°C to 60°C		

Product specifications are subject to change without further notice.